

COMPANY



**Kitchen manufacturers
since 1977**

Located in:

CO-3103, kilometric point 10
Villafranca de Córdoba
Córdoba (Spain)

STAFF

We are proud of all our staff members who after years of experience have reached a high degree of responsibility and commitment.

TECHNOLOGICAL STANDING

We invest in the most modern and advanced technology developed by leading woodworking processing companies (IMA, SCHELLING, HOMAG).

RELIABILITY AND SAFETY

Orders are safely delivered in due course using our own transportation means.

TRUSTWORTHINESS

Retailers and commercial partners completely rely on us after four decades of uninterrupted working activity.

COMPETITIVENESS

A balanced quality price relationship makes our products and services highly competitive.

FLEXIBILITY

We adapt dimensions and typologies of our units to the consumer's needs. No technically possible demand is left unattended if it does not affect the final quality of the product.

WARRANTY

The 2 year legal warranty is extended to 5 years in all our products.

SUSTAINABILITY

We follow an environmentally friendly policy through all the production process.

FACTORY

Our kitchen units and all accessories and complements needed for mounting are produced in our approximately 30.000 square metres factory.



QUALITY AND WARRANTY



We obtained the ISO 9001 certificate in 2008 which improved our organization and quality control systems. Periodically every three years we go through an audit carried out by the external auditor BUREAU VERITAS to renew this certificate.



The extended OB five year warranty will cover all material and workmanship defects that may appear in this period.

BOARD cabinet/hull/carcass/frame**Description:**

- Manufactured in particle board, covered on both sides with low pressure laminate 100 gr/m².
- 615-640 kg/m³ density.
- Neutral colour 19 mm width.
- CARB 2 type with low formaldehyde content.
- Manufactured in EU (Spain and France).

Observations:

- Non porous material, highly resistant to wear, abrasion, heat, stain and cracking .The hardness of its surface and its dimensional stability are paramount.
- It makes cleaning easier.

TENONING/GLUING components**Description:**

- Manufactured in solid pine wood.
- 30 mm length.
- 8 mm diameter.
- D2 glue used according to DUN EN204 for cold application.
- Manufactured in UE (Spain).

Observations:

- Pre-glued tenon that facilitates assembling and gives strength and firmness.
- A mechanical press is used in the process.
- All the parts are manufactured and assembled in automatised assembly lines.

ENDINGS componentes**Description:**

- Manufactured in polymeric material or PVC.
- 1,2 mm width front edging.
- 0,4 mm width for the rest of edgings.
- Manufactured in UE (Spain).

Observations:

- All the parts in the cabinet are edged in the same colour.

BACK cabinet**Description:**

- Manufactured in medium-density fibreboard (MDF) covered in both sides by a 100 gr/m² low pressure laminate.
- 615-640 kg/m³ density.
- 6mm width, neutral colour.
- Manufactured in EU (Spain and France).

Observations:

- The back is glued and wedged in the groove to give a greater stability to the cabinet.

Advantages:

- The 6mm width of the back gives strength and firmness to the cabinet carcass.

SHELF cabinet**Description:**

- Manufactured in particle wood covered in both sides by a 100 gr/m² low pressure laminate.
- 615-640 kg/m³ density.
- 19 mm width, neutral colour.
- E1 type with low content in formaldehyde according to UNE-EN 14322 standards.
- Manufactured in UE (Spain and France).

Observations:

- Non porous material, highly resistant to wear, abrasion, heat, stain and cracking .The hardness of its surface and its dimensional stability are paramount.
- It makes cleaning easier.
- The shelf is the same material, design and colour of the door. It can be fixed (standard) or loose (on demand).

Advantages:

- Shelf with a greater resistance to bending.

SHELF SUPPORT/BRACKET cabinet



Description:

- Made up by two pieces: one in a zinc alloy, the other one in ABS plastic.
- It has an inner spring that clicks on the bolt with in/out positions????????????????
- Neutral colour.
- UNE-EN 14749/05 standards.
- Made in UE (Italy).

Observations:

- Anti-turnover locking system.
- Easy and safe transport and assembling.
- Each shelf has four inserted supports/brackets.

Advantages:

- Easy and fast installation.

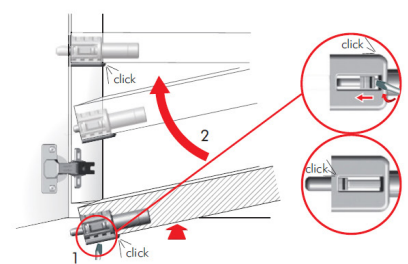
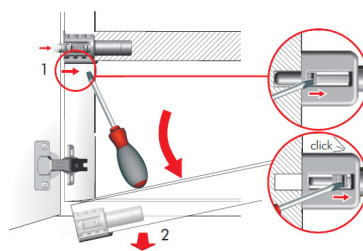

GLASS SHELF SUPPORT/BRACKET cabinet**Description:**

- Made in a zinc alloy.
- Metal colour.
- Adjustable in height from 4 to 10 mm.
- UNI EN 14749 standard.
- Made in UE (Italy).

Observations:

- Anti-turnover system.
- Easy and safe transport and assembling.
- Each shelf has four brackets.

CONCEALED WALL HANGING BRACKET unit

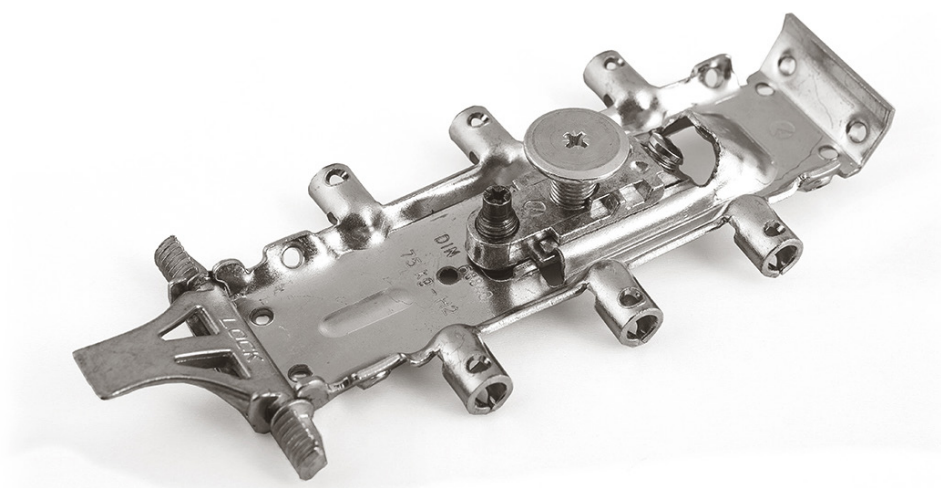

Description:

- Made up in steel covered by a zinc alloy.
- 75 kg weight support capacity for each hanging bracket.
- It can be adjusted up to 13 mm vertically.
- It can be adjusted up to 12 mm in depth. DIN 68840 standard.
- Manufactured in UE (Italy).

Observations:

- Anti-turnover locking system.
- Easy and safe transport and assembling.
- Each unit has two hanging brackets mounted at the back of the unit.
- Each unit has two neutral colour decorative covers.

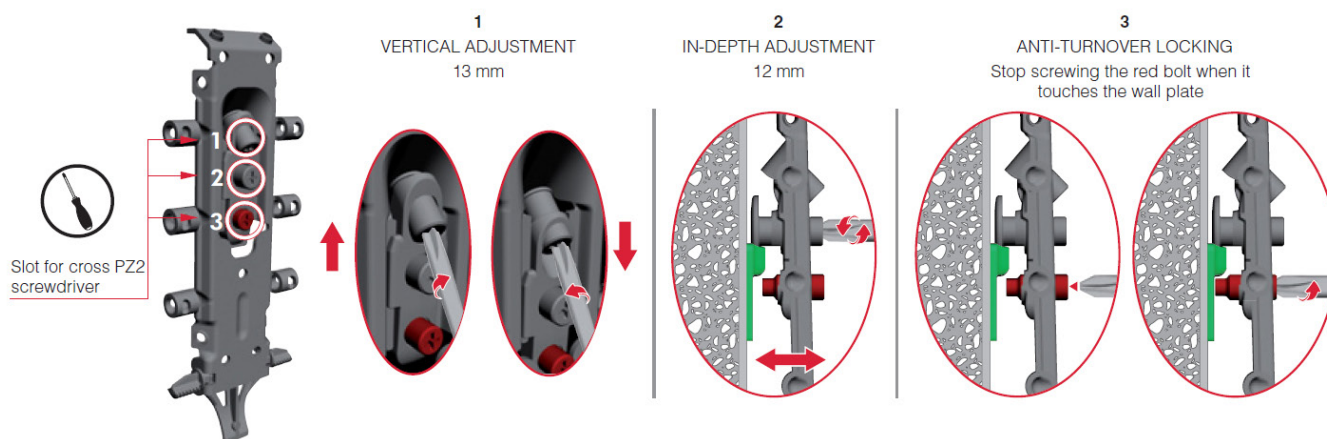

LEGS



Description:

- They are composed by two pieces: one rectangular base with a 1 cm dowel and 6 drill holes for screws + one support piece of adjustable height (100 or 150 mm).
- Manufactured in high quality ABS plastic.
- 569 kg weight support capacity for each leg.
- AIMME 5-07-00264 standard/certificate.
- Manufactured in EU (Spain).

Observations:

- Embedded in drill holes carried out in the bottom of the unit it increases the stability of the unit.

ALUMINIUM BAR



Description:

- Manufactured in extruded aluminium with ABS high quality plastic fixation dowels.

Observations:

- Extra screwing system at the sides of the units.
- Higher resistance to humidity.
- It strengthens the unit structure for transport.
- It can be used as a support for countertops.
- It improves the look of the unit.
- Manufactured in EU (Spain).

Advantages:

- By default the bar is perforated in all stove units.

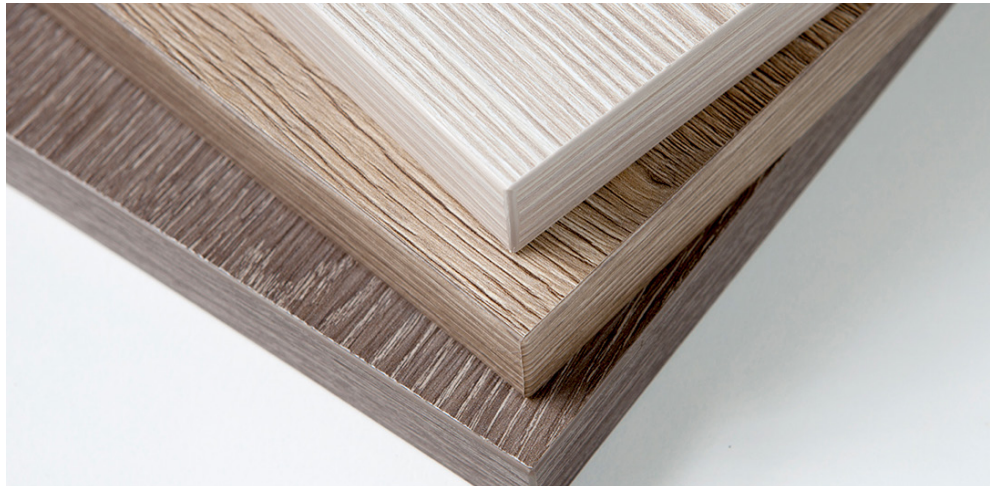
PUR (Poly Urethane Reactive)**Description:**

- Glue used to seal the edges of laminated or stratified doors.
- Manufactured in UE (Germany).

Observations:

- Resistant to humidity due to a better sealing of the edge.
- It does not peel off because of heat.
- Greater adherence.
- It does not wear out.
- It is recyclable.

ANTI-NOISE STOPS



Description:

- Transparent rubberised ABS.
- Manufactured in EU (Italy).

Observations:

- Incorporated as a standard to all fronts/doors.
- It cushions and silence the shock of a closing door.

110° HINGE



Description:

- Nickel-plated steel.
- Slowing down closing mechanism integrated in the concealed hinge.
- Regulating closing drive mechanism integrated.
- Three axis adjustment: side, height and depth adjustments.
- It has a certificate durability (LGA) of 80.000 opening cycles.
- DIN 68 857/ DIN EN 14749 standards.
- Manufactured in EU (Italy)

Observations:

- Complementary hinges: 15°/24°/30°/37°/45°/155°/180°/270°/ -30°. All of them equipped with slowing down closing mechanism but no regulating closing drive mechanism.

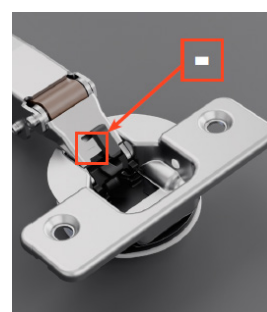

Regulating closing drive mechanism
It regulates the closing drive as
needed



Buffers in silicone oil to ensure uni-
formity in the closing of fronts

DELUXE drawers and pan drawers

Description:

- Silver finish stainless steel.
- Complete pull out guide system with shock absorbing mechanism integrated.
- 30 kg load capacity.
- 70 mm side height.
- 70 mm/144 mm back height.
- 260, 350, 420 and 470 (standard) mm side length.
- +/-2 mm side adjustment.
- +/-2 height adjustment by small scroll, no tools needed.
- LGA certification for a durability of 80.000 opening cycles.
- DIN EN 14749 standards.
- Manufactured in EU (Germany).

Observations:

- Safe and firm union of drawer and guide.
- Easy mounting and dismounting of drawer and front.
- Interior layout program.
- INNER/interior drawers available.

OPTIMUS drawers and pan drawers**Description:**

- White finish stainless steel.
- Complete pull out guide system with shock absorbing mechanism integrated.
- 40 kg load capacity.
- 94 mm side height.
- 94 mm/186 mm back height.
- 270, 350, 450 and 500 (standard) mm side length.
- +/-1.5 mm side adjustment.
- +/-2 height adjustment sound warning.
- LGA certification for a durability of 80.000 opening cycles.
- DIN EN 14749/DIN EN 15338 standards.
- Manufactured in EU (Germany).

Observations:

- Homogeneous and soft slide thanks to synchronization system.
- Optimal distribution of load.
- Minimum pull out force needed.
- Perfect shock absorbing system.
- PUSH opening system without handles (optional).
- Easy mounting and dismounting of drawer and front, no tools needed.
- Interior layout program.
- INNER/interior drawers available.

ELEGANCE drawers and pan drawers**Description:**

- Anti fingerprint stainless steel or matt grey steel.
- Complete pull out guide system with shock absorbing mechanism integrated.
- 40 kg load capacity.
- 90.5 mm side height.
- 128 mm/177 mm back height.
- 270, 350, 450 and 500 mm side length.
- +/-1.5 mm side adjustment.
- +/-2 height adjustment.
- LGA certification for a durability of 80.000 opening cycles.
- DIN EN 14749/DIN EN 15338 standards.
- Manufactured in EU (Austria).

Observations:

- Homogeneous and soft slide thanks to synchronization system.
- Optimal distribution of load.
- Minimum pull out force needed.
- Perfect shock absorbing system.
- PUSH opening system without handles (optional).
- Easy mounting and dismounting of drawer and front.
- Interior layout program.
- INNER/interior drawers available.

HK lift up systems

Description:

- Adjustable lift up system.
- 18 kg maximum load per front with two HK mechanisms.
- LGA certification for a durability of 80.000 opening cycles.
- DIN EN 14749/DIN EN 15338 standards.
- Manufactured in EU (Austria).

Observations:

- No hinges are needed.
- Ideal for small and medium wall units.
- Mechanical opening system without handles TIP ON (optional).

HF lift up systems



Description:

- Adjustable lift up system.
- LGA certification for a durability of 80.000 opening cycles.
- DIN EN 14749/DIN EN 15338 standards.
- Manufactured in EU (Austria).

Observations:

- Ideal for wall units.

HS lift up systems



Description:

- Tilting adjustable lift up system.
- LGA certification for a durability of 80.000 opening cycles.
- DIN EN 14749/DIN EN 15338 standards.
- Manufactured in EU (Austria).

Observations:

- No hinges are needed
- Ideal for medium-height wall units.

HL lift up systems



Description:

- Vertical adjustable lift up system.
- LGA certification for a durability of 80.000 opening cycles.
- DIN EN 14749/DIN EN 15338 standards.
- Manufactured in EU (Austria).

Observations:

- No hinges are needed.
- Ideal for microwave with a gapunits.

JUNIOR PANTRY interior equipment**Description:**

- Complete pull out opening system.
- Guides with shock absorbing mechanism integrated.
- Baskets with flat chrome bars and anti-slip base.
- 60 cm width.
- Manufactured in EU (Germany).

Observations:

- Optimal design for any needs.
- Many possibilities of personal adaptations.
- Easy and fast mounting.
- It can be mounted from the top even in small width units.
- 3D real adjustment allowing alignment of the front in a short time.

CONFORT PANTRY interior equipment**Description:**

- Complete pull out opening system.
 - Bread basket/bottle rack: 2 wire trays / 1 bottle tray.
 - Bottle rack: 3 bottle trays.
 - Trays: 3 trays.
- Guides with shock absorbing mechanism integrated.
- 30 cm width.
- Manufactured in EU (Germany).

Observations:

- Optimal visibility and easy reach.
- Many possibilities of personal adaptations.
- Maximum use of the unit.

**Description:**

- Revolving opening system for fix corner.
- Tray with flat chrome bar and anti slip base.
- 25 kg load capacity for each tray.
- Completely functional with an 85° door opening angle.
- Easily adjustable in height.
- Manufactured in EU (Germany)

Observations:

- All the objects are shown in a single movement outside the unit.
- The trays move independently.
- Maximum use of the unit.
- Trays are available in grey, white and anthracite finish.

PREMIUM interior equipment

Description:

- Complete pull out opening system.
 - Pantry: 3 trays with a 25 kg load capacity each.
 - Bread basket.
 - Bottle rack.
- Guides with shock absorbing mechanism integrated.
- LGA certification for a durability of 60.000 opening cycles.
- DIN EN 14749/DIN EN 15338 standards.
- Manufactured in EU (Italy).

Observations:

- Maximum use of the unit.

NINKA interior equipment

Description:

- Revolving opening system for corner.
- Easy and comfortable closing.
- No tools are needed for the adjustment of the closing speed.
- Individual adjustment of the tray height.
- Easy mounting of side units.
- Manufactured in EU (Germany)

Observations:

- Maximum use of unit.

iMOVE interior equipment for tall/wall units

Description:

- Pull out ergonomic system for storage in tall/wall units.
- The objects in the unit can be seen and reached more easily as they are moved downwards.
- Simple of use.

Observations:

- One or two trays are possible depending on the dimensions of the unit.

SLIDE sliding doors auxiliaries

Description:

- Single rail sliding door system.
- Easy to mount.
- Maximum use of spaces.

Observations:

- They are formed by the combination of display units + fronts.
- Different heights and widths available for base and wall units as well.

Q20 Metallic Shelves auxiliaries**Description:**

- Modular system of metal shelves for hanging, composed by aluminium tubular structure and decorative shelves.
- Measures:
 - Width: from 30 up to 160 cm.
 - Height: 35, 40, 45, 70 and 90 cm.
 - Depth: 30 cm.
- Finish: black matte lacquered.

BOLD Showcases auxiliaries**Description:**

- Decorative modulation comprising:
 - View module.
 - BOLD showcase front in matt black lacquered finish and TEMPERED SMOKED glass.
 - 8mm glass shelves.
 - Hinges and shelf supports in titanium finish.
 - Black concealed hanger trim.

Observations:

- Optional interior vertical/horizontal lighting is available.

LINERO MOSAIQ accessories



Description:

- Multifunction profile for work area.
- Anodized aluminium stainless steel look finish.
- A variety of different dimension accessories available, to achieve the most suitable kitchen layout.

Observations:

- It is possible to fit a led light system into the profile.
- Even more, with the Eboxx accessory, an extra plug can be added.

LIGHTING

Lighting is becoming more and more important in the kitchen. OB offers to its suppliers a great range of interior and surface lighting products.

Surface
Work area



Interior
Pan drawers



Surface
Ambient light





Surface
Work area



Exterior
Wall units



Interior
Decorative modules

PACKAGING

Modules, accessories and complements are efficiently packaged to prevent impacts or scratches while loading, transporting and downloading.



70 | 80 CONCEPT modulation

OB has two modulation programs differentiated according to the HEIGHT of the base units (70 or 80 cm).

The standard depth for units is:

Wall units : 35 cm+front.

Base units : 57 cm+ front.

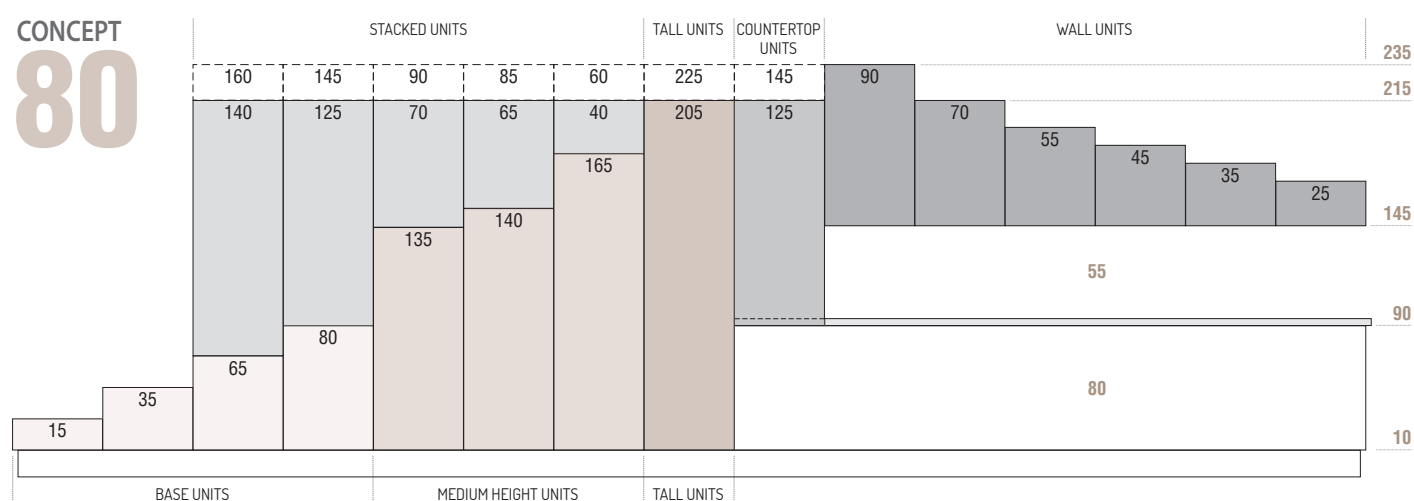
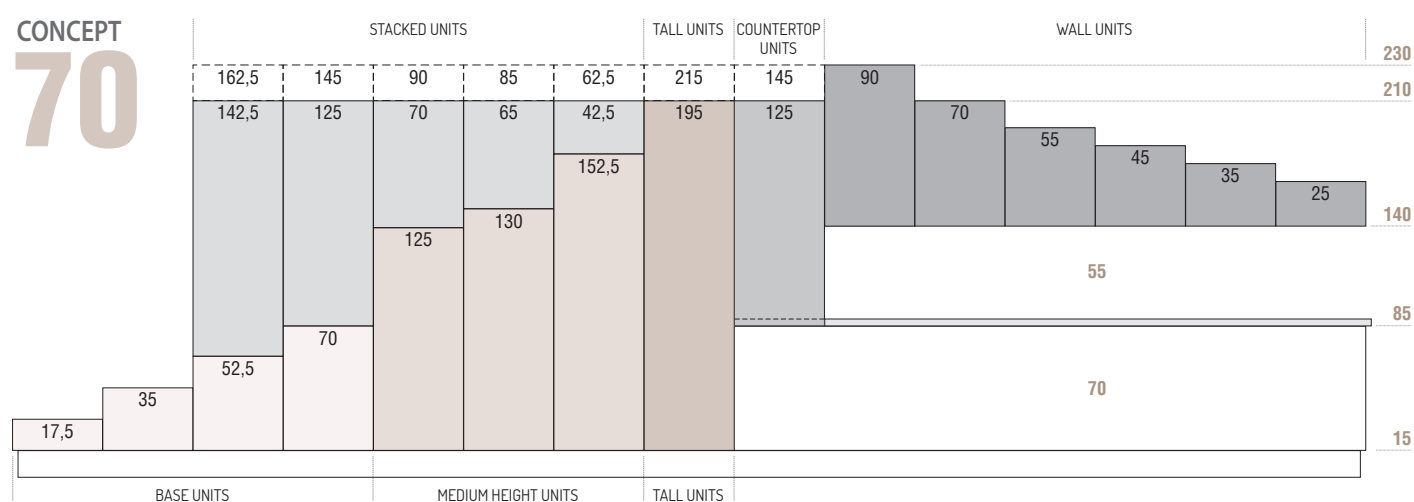

80 CONCEPT

The 80 Concept developed by OB improves three major features:

- It optimises the working position.
- It offers up to 15% increase in storage capacity.
- It redesigns the general aesthetics of base units.

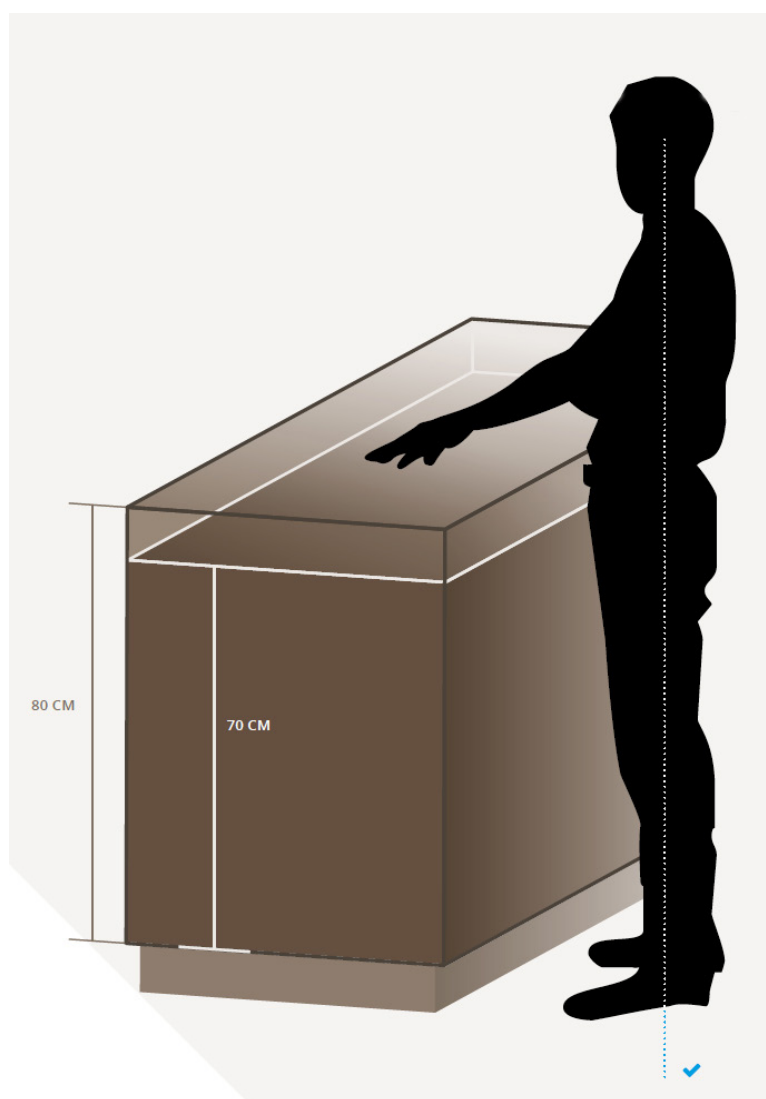

DOUBLE WALL UNITS module program

The double wall unit offers a functional and beautiful solution when horizontal wall units are required. They can be up to 160 cm wide.

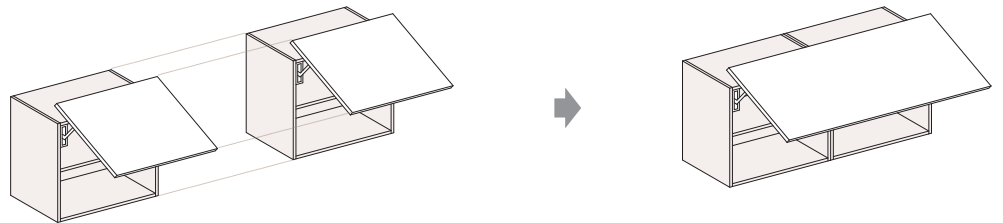

STACKED UNITS module program

This module program allows forming high units in a practical solution for loading, transporting and mounting.

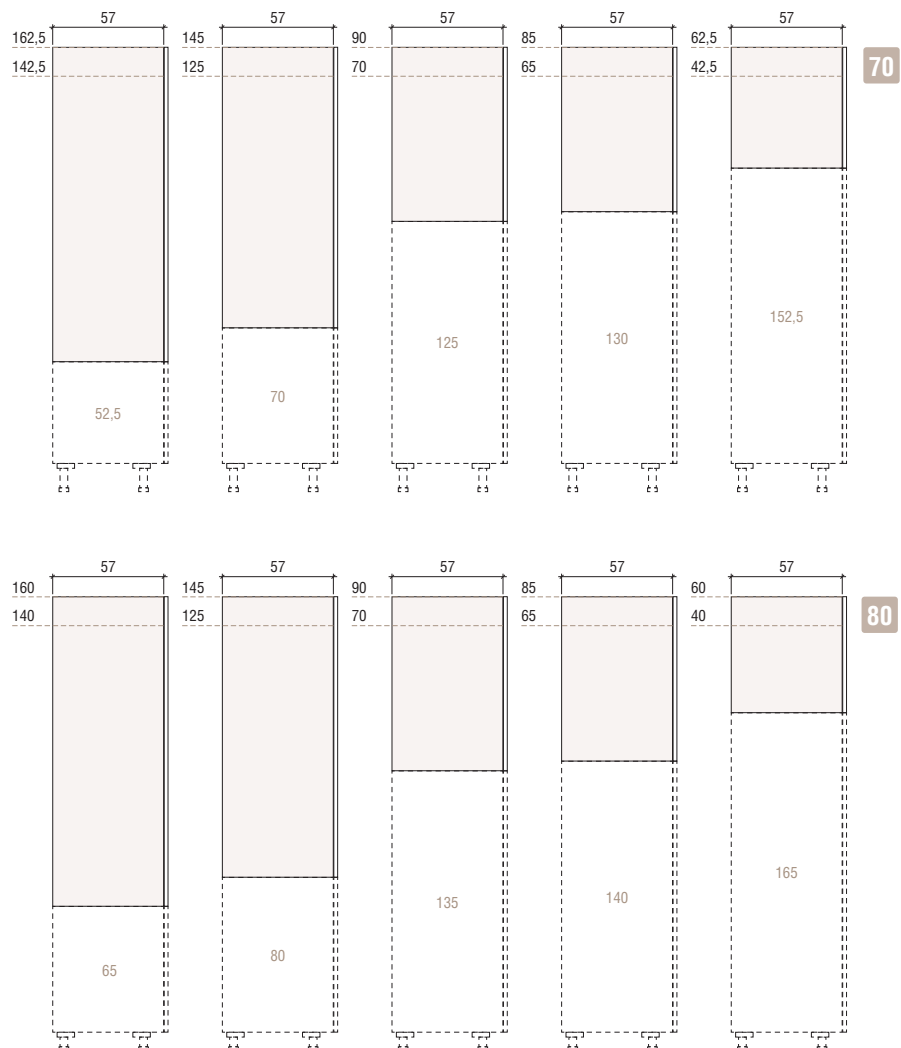

SINK BASE UNIT module program

These units are completely open in their top part and partially at the back to facilitate the fitting and fixing of the sink. The bottom part is recessed creating a 50 mm gap to allow the passing of cables and drain pipes. As a standard, it is equipped with a protective liner and a metallic profile.

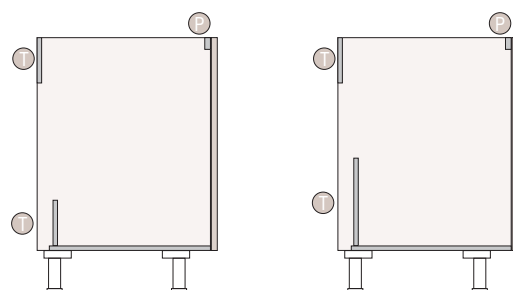

- T Panels the same as the frame
- P Metallic profile

Marine Panel

The bottom part and the low back panel in most of our sink base units can be substituted for marine panels.

Metallic Profile

- It Improves resistance to water spillage.
- it provides greater stability to the unit.
- It supports the countertops.



Sink Base Unit Liner Protector

- It avoids direct contact with liquids and detergents.
- It improves surface resistance to scratching.
- It protects against possible water spillage or leaks.



STOVES module program

These units are completely open in their top part and partially at the back, enough to facilitate the ventilation of the stoves. The bottom part is recessed leaving a 20 mm gap to improve ventilation. As a standard, they are equipped with metallic front and back profiles to improve stability and support the stoves. The metallic profile is drilled. All hob units are prepared for induction stoves.

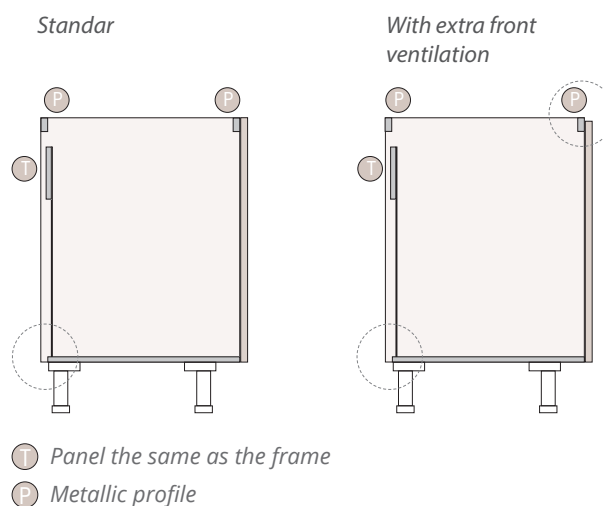

Front Metallic Profile

- It gives more stability to the unit.
- It supports the countertop.
- It improves the ventilation of the stove.



Flat Gola and L Gola Profiles

- Both profiles can be sent with drill holes and slots to facilitate the ventilation of the stoves.

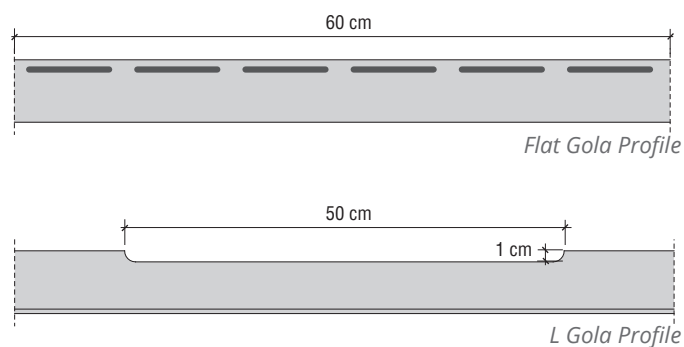

GOLA module program

OB has one of the most extensive GOLA unit programs in market. There are two types of GOLA modulation. The so called "fake" gola and the OB gola with its corresponding hulls for two types of profiles: FLAT or L profile.

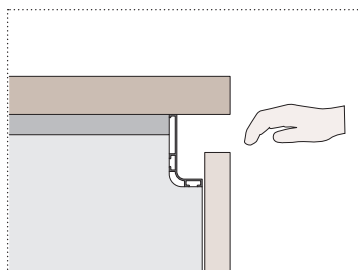

L Gola

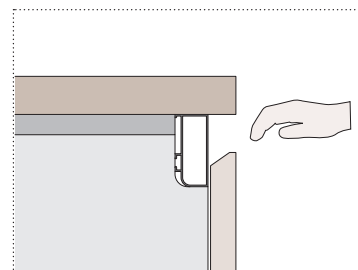

Flat Gola

Besides these two profiles there is another standardised profile that is used in our wall units modulation program:

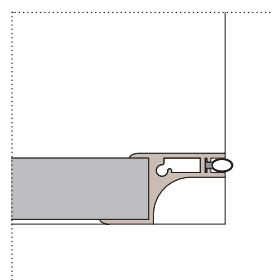

Profile detail for wall unit

HORIZONTAL AND VERTICAL profiles can also be differentiated, according to the orientation of the units. Vertical Gola profiles are available for TALL units:

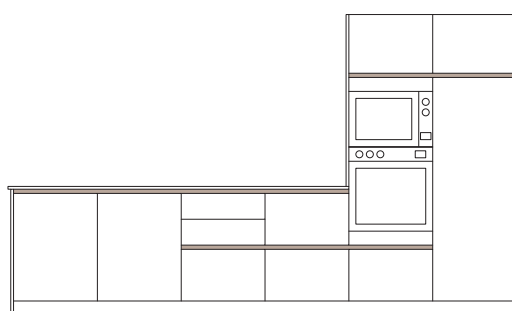

Horizontal Gola

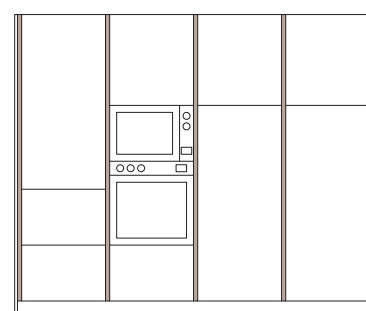

Vertical Gola

From this point on we develop our own catalogue with units of different types and uses:

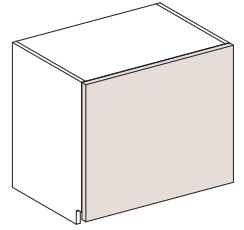
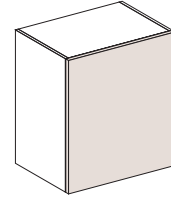
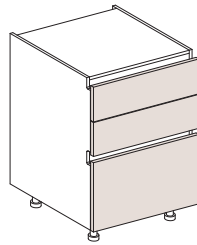
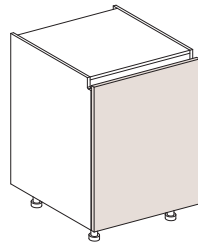

Base Units

Wall Units

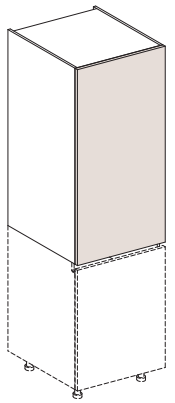
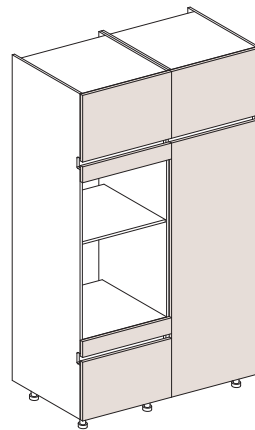
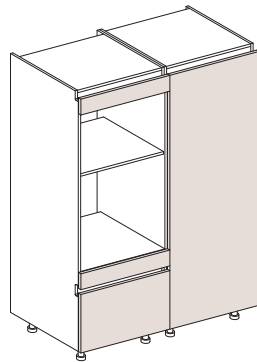

Semi columns/Mid Height Units

High Units

Stacked Units



ON DEMAND SPECIAL DIMENSIONS module program

OB offers to distributors an extensive on demand special dimension units program of an extraordinary flexibility.

- INCREASE OR DCREASE IN DEPTH
- FALSE SQUARES AND PILLARS
- SIDE CUT
- CORNER CUT
- BACK CUT (HIGH OR LOW)
- LEFT OR RIGHT SIDE CUT
- RECESS CENTRAL CUT
- RIGHT OR LEFT FRONT CUT
- DOUBLE CUT

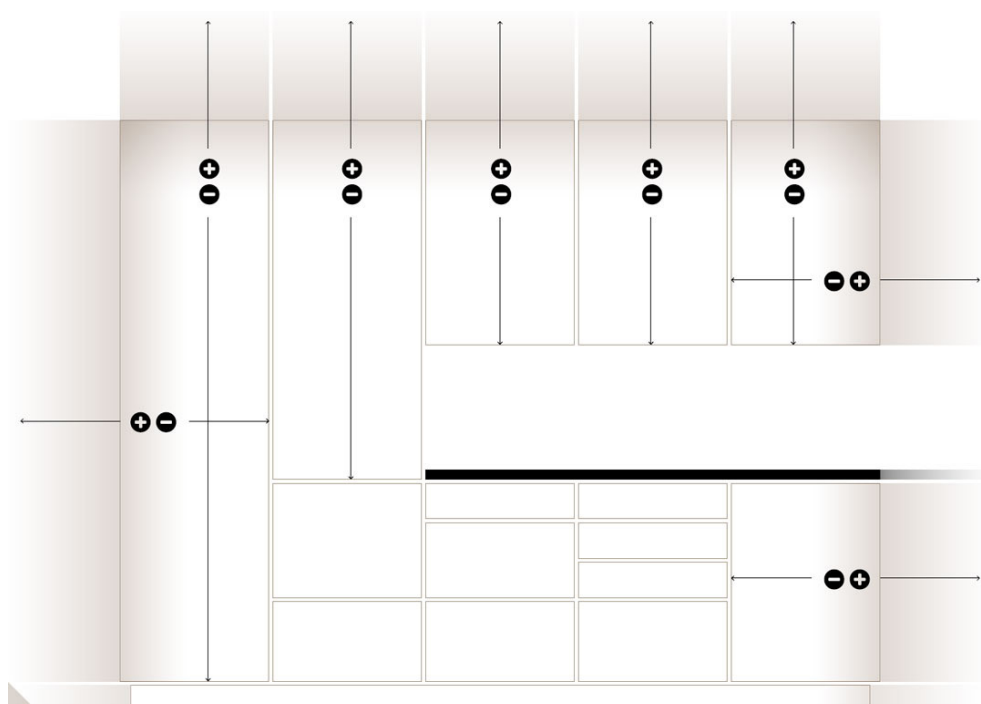

CUSTOMISATION module program

We offer the possibility of customising most of our units using any PVC edge.



ONE-PIECE DOORS module program

In our module program we manufacture 165 cm maximum height doors, but depending on the model and the unit we can go as far as 225 cm. In these cases we incorporate antibending profiles in the back of the front to avoid possible warping due to its big dimensions.

AUTOMATIC DRILLING for handles

OB offers you the possibility of ordering doors and fronts with drill holes for handles. There are different options of automatic drill holes:

Fronts and Showcases

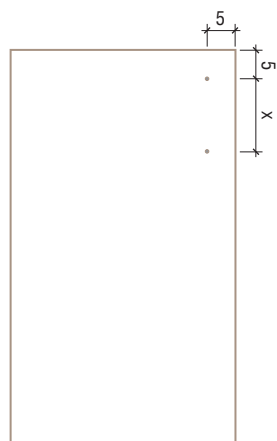

Vertical *

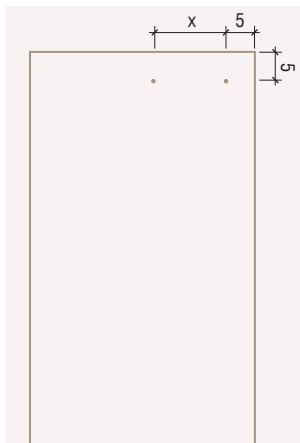

Horizontal

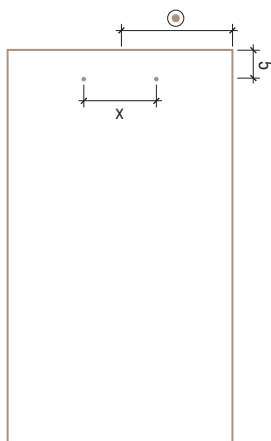

Centred Horizontal

- ⊙ Centred
- x Distance between the centres of the handle

3 posibilidades a elegir:

- Vertical
- Horizontal
- Centred Horizontal

(*) By default it will always be placed Vertical

Drawers and Pan Drawers

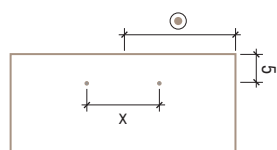

Centred Horizontal **

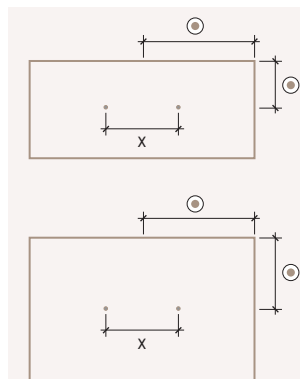
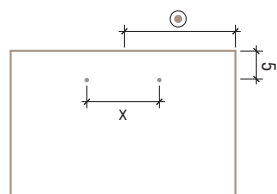

Total Center

2 possibilities to choose:

- Centred Horizontal
- Total Center.

(**) By default it will always be placed Centred Horizontal.

Lift-up Doors

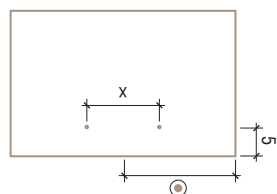

Centred Horizontal

In lift-up doors the front will always be drilled with the Centred Horizontal option

FRONTS features**MATERIALS****4 edges laminate**

Particle board. Kraft paper sheets of different thickness with a smooth matte finish or imitating wood grain finish. All imitating wood grain finish designs are available VERTICALLY or HORIZONTALLY. Wear resistant and easy to clean. PVC edge option depending on model. Also ACRILIC edge option with two layers, three layers, wood or domino designs. Edged using PUR glue.
Catalogue: 49 different designs.

4 edges laminate

DM/MDF (Medium-density fibreboard). Kraft paper sheets of different thickness in matte or glossy lacquer finish. All imitating wood grain finish designs are available VERTICALLY or HORIZONTALLY. Wear resistant and easy to clean. ACRILIC edge depending on model with two layers, three layers, wood or domino designs. Edged using PUR glue.
Catalogue: 16 different designs.

4 edges lacquer laminate

DM/MDF (Medium-density fibreboard). Kraft paper sheets of different thickness in matte or glossy lacquer finish. All imitating wood grain finish designs are available VERTICALLY or HORIZONTALLY. Wear resistant and easy to clean. ACRILIC edge depending on model with two layers, three layers, wood or domino designs. Edged using PUR glue.
Catalogue: 16 different designs.

4 edges layer

Particle board. Sheets of paper of different thickness impregnated with melamine resins in glossy finish. Wear resistant and easy to clean (e.g. YESTE). PVC edge depending on model. Two-coloured ACRILIC edge depending on model. Edged using PUR glue.
Catalogue: 14 different designs.

Wood

MDF smooth veneered front. The veneers are processed and dyed using different types of wood : oak, walnut, beech, cherry, pine. Satin varnish, matte or lacquer finish depending on model. Water-based dyes are used.
Catalogue: 40 different designs.

Lacquer

MDF front, 19 or 22 mm wide. Glossy, matte, textured (rough) finish. 33 standard colours. Any other colour available from the NCS or RAL charts.

RAL lacquer colours

33 standard lacquer colours. NCS and RAL colour charts are available in GLOSSY, MATTE, TEXTURED, METALLIC and STONE finish.



LABELLING OB kitchen retailers

It is well known that the identification of the distribution point and the brand name helps the product to be sold. There are different formats available for our retailers for both exterior and interior use.



KITCHEN MANUFACTURING SECTOR MAGAZINES advertising articles

OB appears periodically in magazines specialised in the kitchen manufacturing sector.

- COCINAS & BAÑOS
- COCINAS & BAÑOS PROFESIONAL
- COCINAS & BAÑOS REFORMAS
- COCINA INTEGRAL
- ARQUITECTURA Y DISEÑO
- L'OFFICIEL
- CUISINES & BAINS



WEB

OB operates an updated and dynamic website in three languages (Spanish, French and English) offering its retailers an online service of queries and downloads. The website www.obcocinas.com is the first one to appear in the SEO positioning ranking under the key word FABRICA DE MUEBLES DE COCINA. We invest in payment positioning (SEM) by ADWORD and DISPLAY actions in targeting consumers and design or architectural companies.

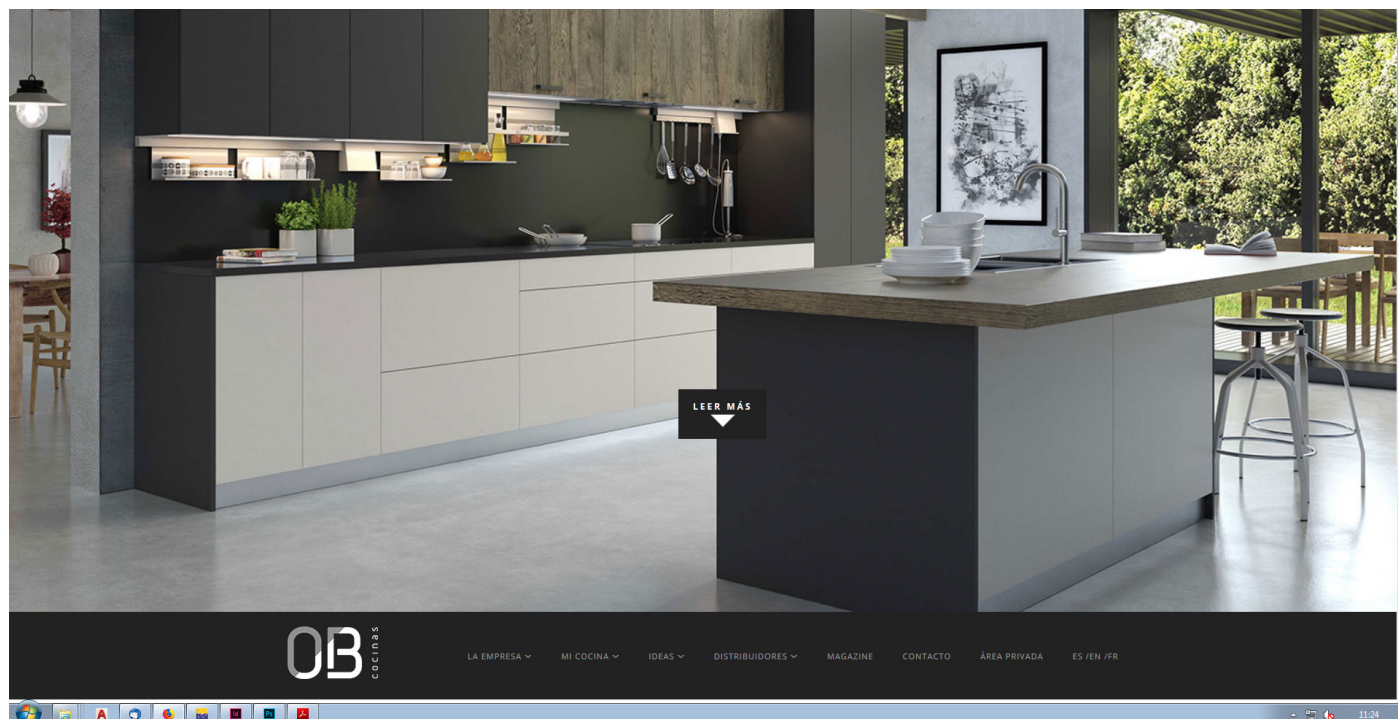

PRIVATE AREA

- Orders information.
- Downloading of documents (catalogues, technical files, portfolios, etc)
- Downloading of software.
- Information on products.

SOCIAL NETWORKS

OB is active on the most important social networks.

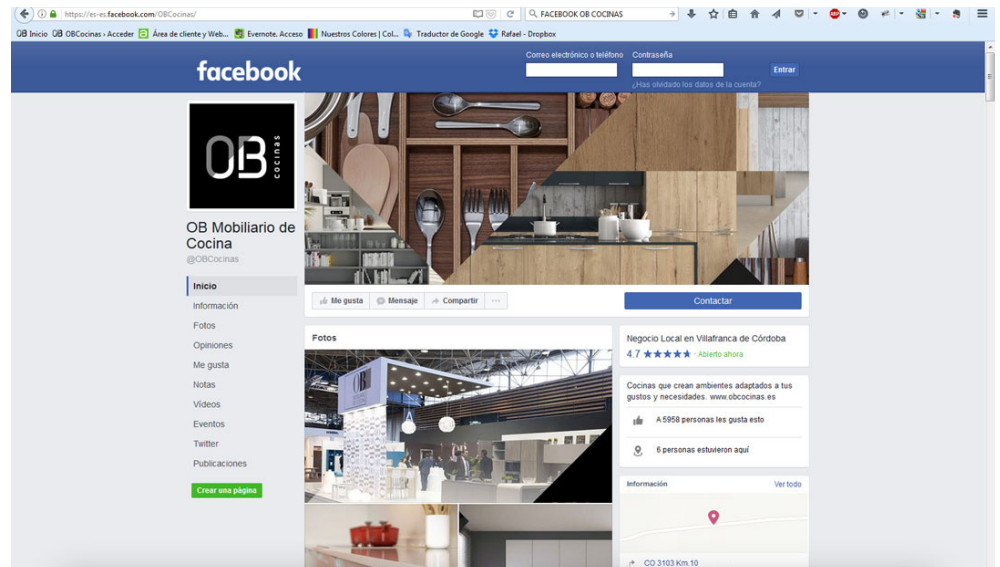

INTERNATIONALISATION

Committed to internationalisation OB is increasingly present in foreign countries.



SPAIN
FRANCE
USA
UNITED ARAB EMIRATES
INDIA
OMAN
PORTUGAL
COLOMBIA
DOMINICAN REPUBLIC
GUATEMALA
SENEGAL
MOROCCO
ALGERIA



c o c i n a s

Muebles OB, S.A.
Córdoba España

T: 957 191 200
Export: +34 957 191 213
F: 957 190 364

www.obcocinas.es